

Path  
Concept  
House

2503 Parker Street,  
Omaha, NE 68111.

Torti Gallas and Partners, Inc.  
1300 Spring Street,  
4th Floor  
Silver Spring, MD 20910  
301.588.6800  
www.tortigallaschk.com

Owner  
Brighton Construction Co  
Phone: 402.434.2456  
Fax: 402.434.2458  
1941 K Street  
Lincoln, NE 68510

Project Management  
Newport Partners LLC  
Phone: 301.888.0017  
Fax: 301.888.0019  
3780 Tanglewood Lane  
Davidsonville, MD 21035  
www.Newportpartnersllc.com

These construction documents were prepared specifically for the project site located at 2503 Parker Street, Omaha, NE. Subsequent use and/or modification of these documents for any project is strictly prohibited unless the documents are reviewed, modified and sealed by a registered architect in the jurisdiction of the proposed project for code compliance, constructability and site adaptation; the project is a HUD project; and, all users and the registered architect agree to defend, indemnify, and hold harmless Torti Gallas And Partners, Inc., its successors and the past, present and future employees of all of them, from all claims, losses, damages, judgments, cost, including reasonable attorney fees, and expenses that relate to or arise, in any way, out of the use or modification of the documents for other projects. Torti Gallas And Partnership, Inc. retains all common law and statutory copyrights in these documents and their content. Any copying, use or modification of these documents without strict adherence to these conditions will be prosecuted as a violation of these copyrights.

Key Plan

Revisions

No. 01 Date 11/24/06  
General Revisions

Wall Types

Date  
10/31/06

Principal In Charge  
B.K.

Project Designer  
M.B.

Project Architect.  
F.S.

Drawn  
B.K., F.S.

Job No.  
05127.03

Scale  
1/2" = 1'- 0"

Drawing No.

A701

NOTES FOR ROOF ASSEMBLIES

RWJ3

ROOF TYPE SYMBOL

1ST LETTER INDICATES FLOOR OR ROOF  
F FLOOR  
R ROOF  
2ND LETTER INDICATES STRUCTURAL MATERIAL  
C CONCRETE  
S STEEL  
W WOOD  
3RD LETTER INDICATES TYPE OF FRAMING  
T ROOF TRUSSES  
R ROOF RAFTERS  
J JOISTS  
I "I" SHAPED JOISTS  
O OPEN WEB TRUSSES  
B "B" BEAMS  
P POURED IN PLACE CONCRETE  
T POST TENSION SLAB  
4TH SPACE IS FOR ASSEMBLY NUMBER  
5TH SPACE INDICATES TYPE OF INSULATION IF USED  
R RIGID INSULATION  
B BLOWN INSULATION

NOTES FOR FLOOR ASSEMBLIES

FWJ3

FLOOR TYPE SYMBOL

1ST LETTER INDICATES FLOOR OR ROOF  
F FLOOR  
R ROOF  
2ND LETTER INDICATES STRUCTURAL MATERIAL  
C CONCRETE  
S STEEL  
W WOOD  
3RD LETTER INDICATES TYPE OF FRAMING  
T ROOF TRUSSES  
R ROOF RAFTERS  
J JOISTS  
I "I" SHAPED JOISTS  
O OPEN WEB TRUSSES  
B "B" BEAMS  
P POURED IN PLACE CONCRETE  
T POST TENSION SLAB  
4TH SPACE IS FOR ASSEMBLY NUMBER  
5TH SPACE INDICATES TYPE OF INSULATION IF USED  
S SOUND INSULATION  
R RIGID INSULATION  
- NO INSULATION

NOTES FOR WOOD, CONCRETE  
MASONRY UNIT, & CONCRETE WALLS

WI  
47

WALL TYPE SYMBOL

1ST LETTER INDICATES PRIMARY MATERIAL  
B BRICK  
C CONCRETE  
D WOOD FURRING  
F STEEL FURRING  
M MASONRY  
N STONE  
S STEEL STUDS  
W WOOD STUDS

2ND LETTER @ INTERIOR WALLS  
INDICATES INSULATION  
I BATT INSULATION  
O NO INSULATION

2ND LETTER @ EXT WALLS INDICATES EXT FINISH  
MATERIAL (ALL EXT WALLS HAVE BATT INSUL)  
A ALUMINUM PANELS  
B BRICK  
E EXTERIOR INSULATION FINISHING SYSTEM  
F FIBER CEMENT PANELS  
K CURTAIN WALL  
M CMU  
N STONE  
P PRECAST  
S STUCCO  
X SIDING

BOTTOM NUMBERS FOR WOOD, CONCRETE, OR MASONRY  
WALLS

|       | WOOD<br>FURRING (D) | WOOD<br>STUDS (W) | CONC (C) OR<br>MASONRY (M) |
|-------|---------------------|-------------------|----------------------------|
| 00-09 | 1 X 2S              | 1 X 2S            |                            |
| 10-19 | 2 X 2S              | 2 X 2S            |                            |
| 20-29 | 2 X 3S              | 2 X 3S            |                            |
| 30-39 | 2 X 4S              | 2 X 4S            |                            |
| 40-49 | 2 X 4S              | 2 X 4S            | 4" THICK                   |
| 50-59 | 2 X 6S              | 2 X 6S            |                            |
| 60-69 | 2 X 6S              | 2 X 6S            | 6" THICK                   |
| 70-79 | CHASE WALLS         | CHASE WALLS       | CHASE WALLS                |

ROOF CEILING ASSEMBLIES

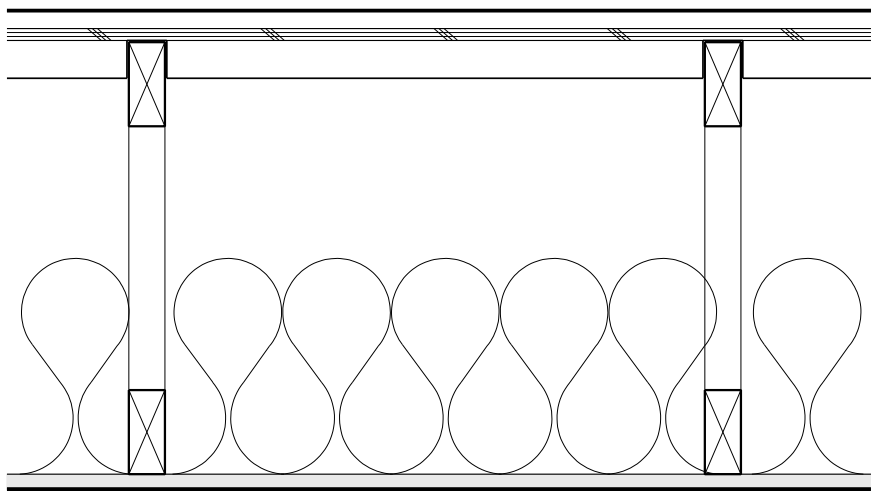

STANDING SEAM METAL ROOF  
15# FELT (1 LAYER IF SLOPE IS GREATER THAN 4:12) (2 LAYERS IF SLOPE IS  
BETW 3 TO 4:12)  
1/2" OSB SHEATHING W/ CLIPS (SIMPSON PSC OR EQUAL)  
1 1/2" OF AIR GAP WITH RAFTER CAPS  
TYVEC ATTICWRAP  
WD TRUSSES @ MAX 24" OC UOI  
SEE ROOF FRAMING PLANS  
R-30 INSULATION - OR  
BIOBASED SYSTEMS 501 SPRAY FOAM  
1/2" GYP BD  
(PROVIDE MODIFIED BITUMEN UNDERLAYMENT FROM EAVE TO BEYOND - 24"  
INSIDE INTERIOR FACE OF EXT WALL)

RWT6B

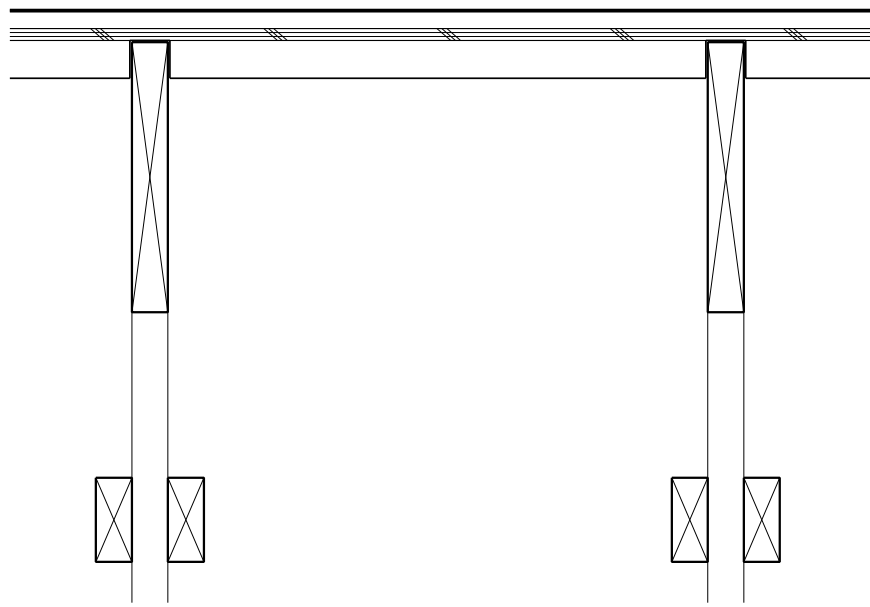

STANDING SEAM METAL ROOF  
15# FELT (1 LAYER IF SLOPE IS GREATER THAN 4:12) (2 LAYERS IF SLOPE IS  
BETW 3 TO 4:12)  
1/2" OSB SHEATHING W/ CLIPS (SIMPSON PSC OR EQUAL)  
1 1/2" OF AIR GAP WITH RAFTER CAPS  
TYVEC ATTICWRAP  
WD RAFTERS @ MAX 24" OC UOI  
SEE ROOF FRAMING PLANS  
(PROVIDE MODIFIED BITUMEN UNDERLAYMENT FROM EAVE TO BEYOND - 24"  
INSIDE INTERIOR FACE OF EXT WALL)

RWR1

FLOOR CEILING ASSEMBLIES

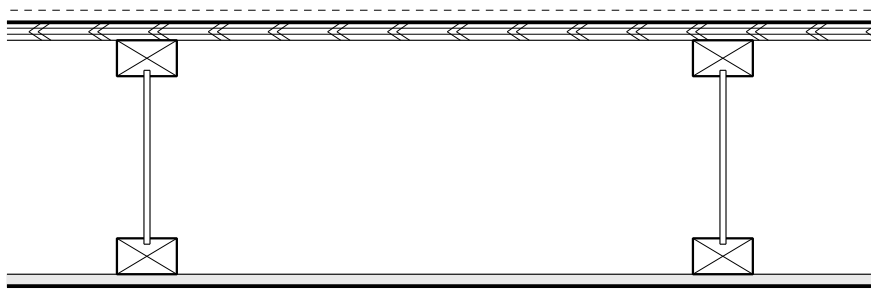

FINISH FLOOR AS SCHEDULED  
3/4" T & G PLYWOOD SUBFLOOR GLUED & NAILED  
PLYWOOD WEB JOISTS (FOR SIZING & SPACING SEE FLOOR FRAMING  
PLANS)  
1/2" GYP BD

FWI1-

FWI1B

WITH R-19 INSULATION

FLOOR ASSEMBLIES

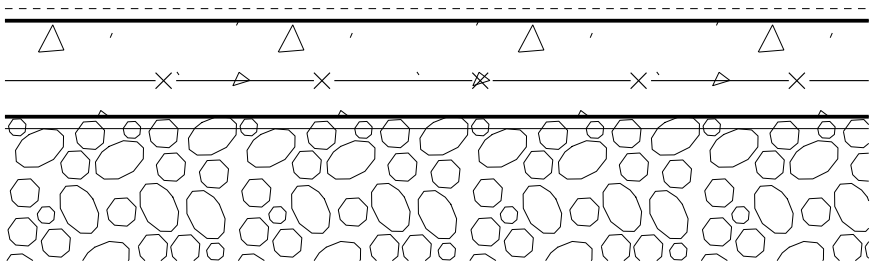

FINISH FLOOR AS SCHEDULED  
MIN 4" CONCRETE SLAB  
WIRE MESH  
VAPOR BARRIER  
DRAINAGE COURSE

FCI-

FCIS

(WITHOUT VAPOR BARRIER)

WALL TYPES

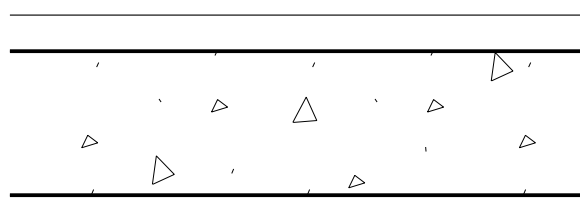

9/16" ICF (PS-3800)

CI  
60

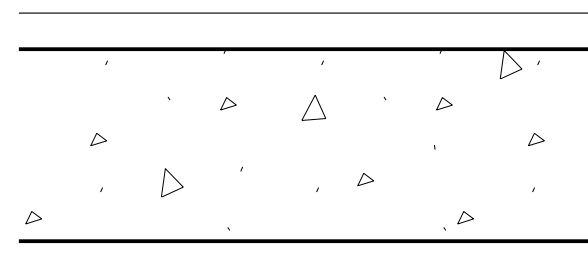

11" ICF (PS-3800)

CI  
80

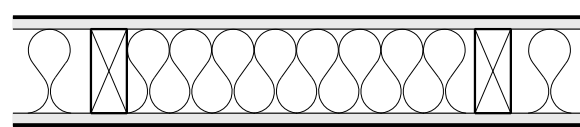

1/2" GYP BD  
2 X 4 WD STUDS  
(BASEMENT AND FIRST FLOOR  
BEARING WALLS @ 16" O.C. - ALL  
OTHER INTERIOR PARTITIONS 24" O.C.)  
R-13 INSULATION - OR  
BIOBASED SYSTEMS 501 SPRAY FOAM  
1/2" GYP BD

WO  
30

W/O INSUL

WI  
30

WI INSUL

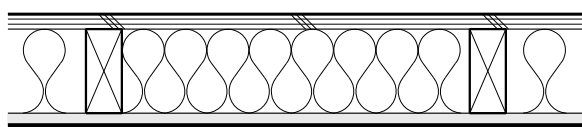

SIDING  
WEATHER BARRIER  
MIN 1/4" OSB OR PLYWD SHEATHING  
2 X 4 WD STUDS  
(FIRST FLOOR EXTERIOR WALLS @ 16" O.C.  
ALL OTHER EXTERIOR WALLS @ 24" O.C.)  
R-13 BATT INSUL - OR  
BIOBASED SYSTEMS 501 SPRAY FOAM  
1/2" GYP BD

WX  
31



SIDING  
WEATHER BARRIER  
MIN 1/4" OSB OR PLYWD SHEATHING  
2 X 4 WD STUDS  
(FIRST FLOOR WALLS @ 16" O.C.  
ALL OTHER EXTERIOR WALLS @ 24" O.C.)

WX  
32

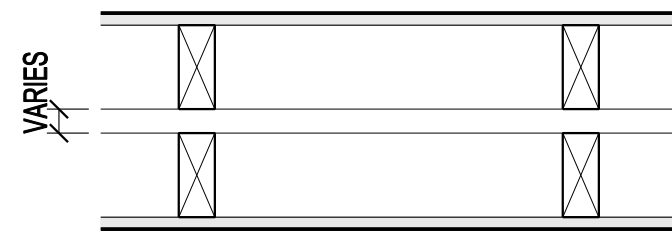

1/2" GYP BD  
2 X 4 WD STUDS @ 24" O.C.  
AIR SPACE  
2 X 4 WD STUDS @ 24" O.C.  
1/2" GYP BD

WO  
70